

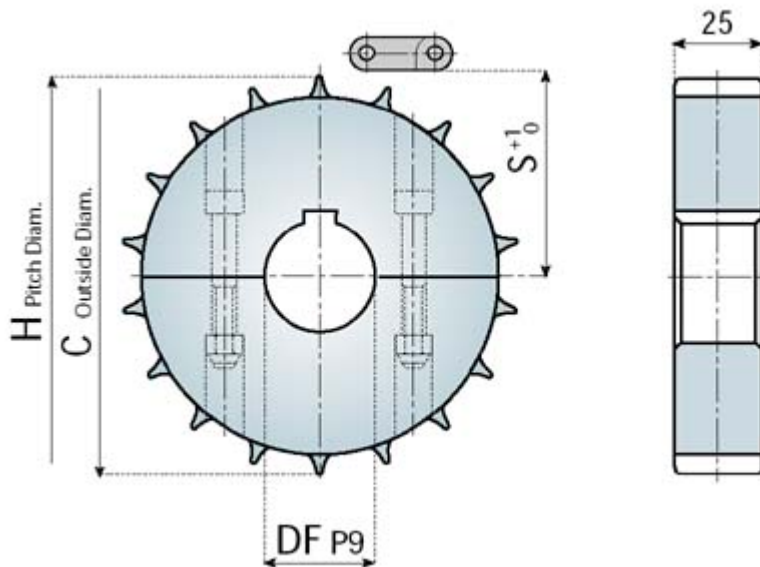

SPROCKETS for belts series

2251 FT - VG - LBP



SPLIT SPROCKETS SINGLE KEYWAY

Material: polyamide, screws in stainless steel. DIN 6885 key seat.

Notes:

- These sprockets can be used for belt widths up to 680 mm and temperature differences of maximum 30°C.
- For wider belts or bigger temperature differences, sprockets with square bores or round bore with two keyway have to be used.
- Special shape of teeth compensates natural belt lengthening after prolonged use.

Features:

- Excellent wear and chemical resistance.
- Reduced noise level and quiet operation
- Reinforced design.
- Completely closed structure, easier to clean and to disinfect
- The design of the sprocket ensures smooth running and long service life.
- Increased keyway strength.

| CODE | Z | C mm | H mm | S mm | DF mm |
|----------|----|---------|---------|---------|----------|
| 125250GF | 16 | 130.0 | 130.20 | 58.7 | 18* |
| 125250F | | | | | 25 |
| 125251F | | | | | 30 |
| 125252F | | | | | 35 |
| 125253F | | | | | 40 |
| 125254GF | 18 | 146.0 | 146.28 | 66.7 | 18* |
| 125254F | | | | | 25 |
| 125255F | | | | | 30 |
| 125256F | | | | | 35 |
| 125257F | | | | | 40 |
| 125258GF | 20 | 162.0 | 162.37 | 74.8 | 18* |
| 125258F | | | | | 25 |
| 125259F | | | | | 30 |
| 125260F | | | | | 35 |
| 125261F | | | | | 40 |

| | | | | | |
|-----------------|----|-------|--------|------|-----|
| 125262GF | 21 | 171.0 | 170.42 | 78.9 | 18* |
| 125262F | | | | | 25 |
| 125263F | | | | | 30 |
| 125264F | | | | | 35 |
| 125265F | | | | | 40 |

*Plain Bore

SPROCKETS for belts series

2251 FT - VG - LBP

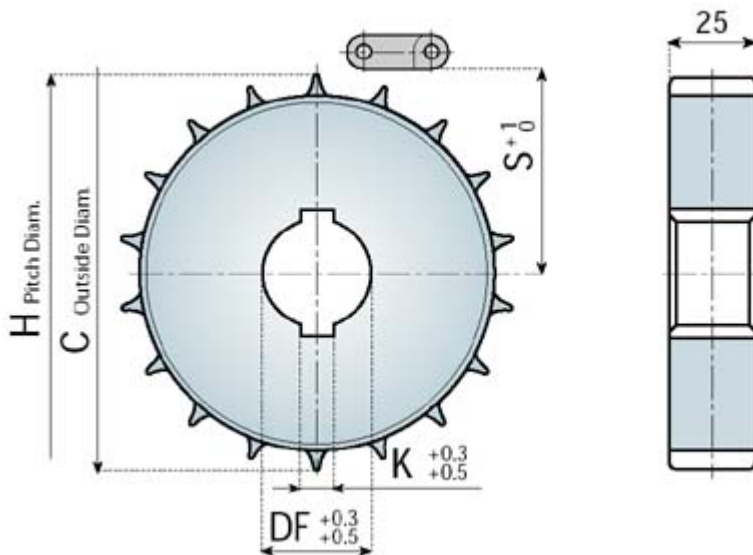

STANDARD SPROCKETS DOUBLE KEYWAY

Material: polyamide, DIN 6885 key seat.

Notes:

- These sprockets can be used on the drive and on the idler shaft. They float freely on the shaft.
- Special shape of teeth compensates natural belt lengthening after prolonged use.

Features:

- Excellent wear and chemical resistance.
- Reduced noise level and quiet operation
- Reinforced design.
- Completely closed structure, easier to clean and to disinfect
- The design of the sprocket ensures smooth running and long service life.
- Increased keyway strength.

| CODE | Z | C mm | H mm | S mm | DF mm |
|-----------------|----|---------|---------|---------|----------|
| 125350GF | 16 | 130.0 | 130.20 | 58.7 | 18* |
| 125350F | | | | | 30 |
| 125351F | | | | | 40 |
| 125352GF | 18 | 146.0 | 146.28 | 66.7 | 18* |
| 125352F | | | | | 30 |
| 125353F | | | | | 40 |
| 125354GF | 20 | 162.0 | 162.37 | 74.8 | 18* |
| 125354F | | | | | 30 |
| 125355F | | | | | 40 |
| 125356GF | 21 | 171.0 | 170.42 | 78.9 | 18* |
| 125356F | | | | | 30 |
| 125357F | | | | | 40 |

SPROCKETS for belts series

2251 FT - VG - LBP

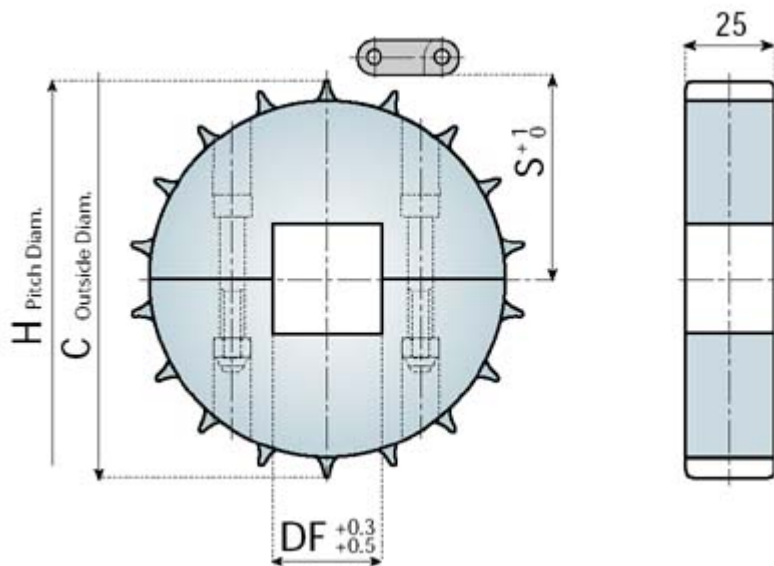

SPLIT SPROCKETS SQUARE BORE

Material: polyamide.

Notes:

- These sprockets can be used on the drive and on the idler shaft. They float freely on the shaft.
- Special shape of teeth compensates natural belt lengthening after prolonged use.

Features:

- Excellent wear and chemical resistance.
- Reduced noise level and quiet operation
- Reinforced design.
- Completely closed structure, easier to clean and to disinfect
- The design of the sprocket ensures smooth running and long service life.

| CODE | Z | C mm | H mm | S mm | SQ mm |
|---------|----|---------|---------|---------|----------|
| 125400F | 16 | 130.0 | 130.20 | 58.7 | 30x30 |
| 125401F | | | | | 40x40 |
| 125402F | | | | | 60x60 |
| 125403F | 18 | 146.0 | 146.28 | 66.7 | 30x30 |
| 125404F | | | | | 40x40 |
| 125405F | | | | | 60x60 |
| 125406F | 20 | 162.0 | 162.37 | 74.8 | 30x30 |
| 125407F | | | | | 40x40 |
| 125408F | | | | | 60x60 |
| 125409F | 21 | 171.0 | 170.42 | 78.9 | 30x30 |
| 125410F | | | | | 40x40 |
| 125411F | | | | | 60x60 |

SPROCKETS for belts series

2251 FT - VG - LBP



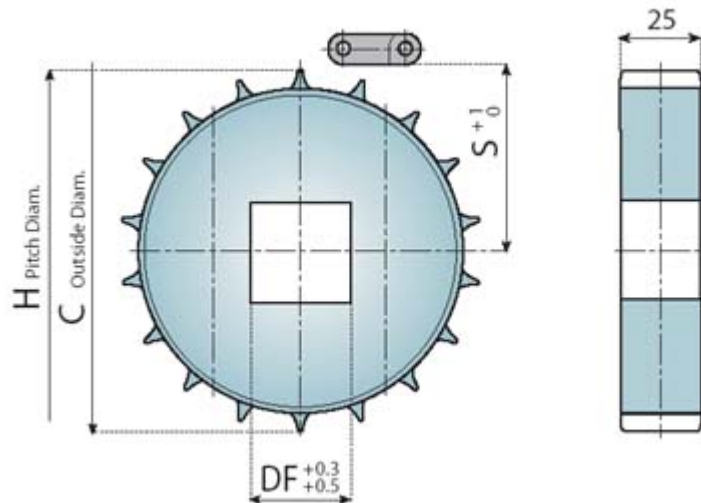

STANDARD SPROCKETS SQUARE BORE

Material: polyamide.

Notes:

- These sprockets can be used on the drive and on the idler shaft. They float freely on the shaft.
- Special shape of teeth compensates natural belt lengthening after prolonged use.

Features:

- Excellent wear and chemical resistance.
- Reduced noise level and quiet operation
- Reinforced design.
- Completely closed structure, easier to clean and to disinfect
- The design of the sprocket ensures smooth running and long service life.

| CODE | Z | C mm | H mm | S mm | SQ mm |
|---------|----|---------|---------|---------|----------|
| 125450F | 16 | 130.0 | 130.20 | 58.7 | 30x30 |
| 125451F | | | | | 40x40 |
| 125452F | | | | | 60x60 |
| 125453F | 18 | 146.0 | 146.28 | 66.7 | 30x30 |
| 125454F | | | | | 40x40 |
| 125455F | | | | | 60x60 |
| 125456F | 20 | 162.0 | 162.37 | 74.8 | 30x30 |
| 125457F | | | | | 40x40 |
| 125458F | | | | | 60x60 |
| 125459F | 21 | 171.0 | 170.42 | 78.9 | 30x30 |
| 125460F | | | | | 40x40 |
| 125461F | | | | | 60x60 |

SPROCKETS for belts series

2251 FT - VG - LBP



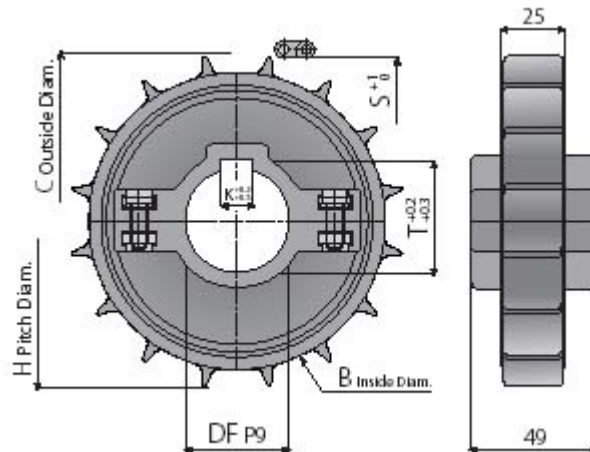

SPLIT SPROCKETS SINGLE KEYWAY

Material: reinforced polyamide, screws in stainless steel, nut in nickel plated brass.

Features:

- Excellent wear and chemical resistance.
- Reduced noise level and quiet operation.
- Reinforced design.
- Completely closed structure, easier to clean and to disinfect
- The design of the sprocket ensures smooth running and long service life.
- Increased keyway strength.

To order single keyway sprockets capable of floating freely on the shaft (i.e. bore tolerance DF +0.3 /+0.5), just add the letter "P" (=plus) to the existing part number.

For example, code **123057P**.

| CODE | Z | B mm | C mm | H mm | S mm | DF mm |
|--------|----|---------|---------|---------|---------|----------|
| 123057 | 16 | 115.1 | 130.0 | 130.2 | 58.7 | 30 |
| 123058 | | | | | | 35 |
| 123059 | | | | | | 40 |
| 123060 | | | | | | 45 |
| 123071 | 18 | 131.2 | 144.0 | 146.3 | 66.7 | 30 |
| 123072 | | | | | | 35 |
| 123073 | | | | | | 40 |
| 123074 | | | | | | 45 |
| 123085 | 20 | 147.3 | 162.0 | 162.4 | 74.8 | 30 |
| 123086 | | | | | | 35 |
| 123087 | | | | | | 40 |
| 123088 | | | | | | 45 |

SPROCKETS for belts series

2251 FT - VG - LBP



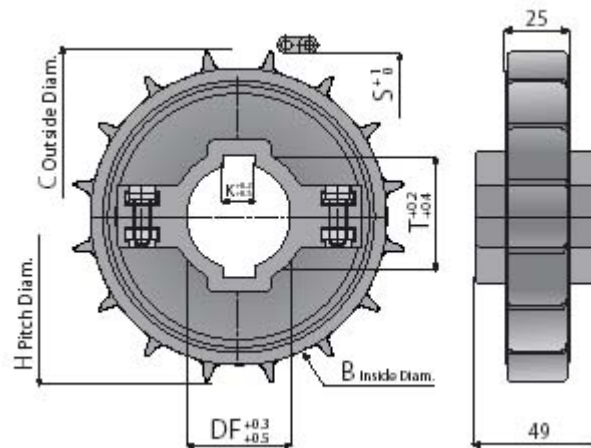

SPLIT SPROCKETS DOUBLE KEYWAY

Material: reinforced polyamide, screws in stainless steel, nut in nickel plated brass.

Notes:

- These sprockets can be used on the drive and on the idler shaft. They float freely on the shaft.

Features:

- Excellent wear and chemical resistance.
- Reduced noise level and quiet operation.
- Reinforced design.
- Completely closed structure, easier to clean and to disinfect
- The design of the sprocket ensures smooth running and long service life.
- Increased keyway strength.

| CODE | Z | B mm | C mm | H mm | S mm | DF mm |
|--------|----|---------|---------|---------|---------|----------|
| 123061 | 16 | 115.1 | 130.0 | 130.2 | 58.7 | 30 |
| 123062 | | | | | | 35 |
| 123063 | | | | | | 40 |
| 123064 | | | | | | 45 |
| 123075 | 18 | 131.2 | 144.0 | 146.3 | 66.7 | 30 |
| 123076 | | | | | | 35 |
| 123077 | | | | | | 40 |
| 123078 | | | | | | 45 |
| 123089 | 20 | 147.3 | 162.0 | 162.4 | 74.8 | 30 |
| 123090 | | | | | | 35 |
| 123091 | | | | | | 40 |
| 123092 | | | | | | 45 |

SPROCKETS for belts series

2251 FT - VG - LBP



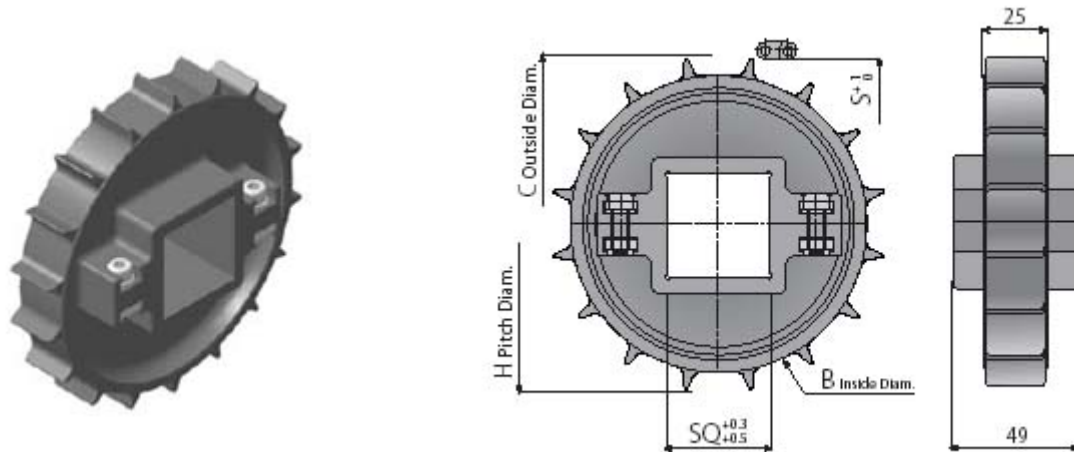

SPLIT SPROCKETS SQUARE BORE

Material: reinforced polyamide, screws in stainless steel, nut in nickel plated brass.

Notes:

- These sprockets can be used on the drive and on the idler shaft. They float freely on the shaft.

Features:

- Excellent wear and chemical resistance.
- Reduced noise level and quiet operation.
- Reinforced design.
- Completely closed structure, easier to clean and to disinfect
- The design of the sprocket ensures smooth running and long service life.

| CODE | Z | B mm | C mm | H mm | S mm | DF mm |
|--------|----|---------|---------|---------|---------|----------|
| 123065 | 16 | 115.1 | 130.0 | 130.2 | 58.7 | 30x30 |
| 123066 | | | | | | 40x40 |
| 123079 | 18 | 131.2 | 144.0 | 146.3 | 66.7 | 30x30 |
| 123080 | | | | | | 40x40 |
| 123093 | 20 | 147.3 | 162.0 | 162.4 | 74.8 | 30x30 |
| 123094 | | | | | | 40x40 |