

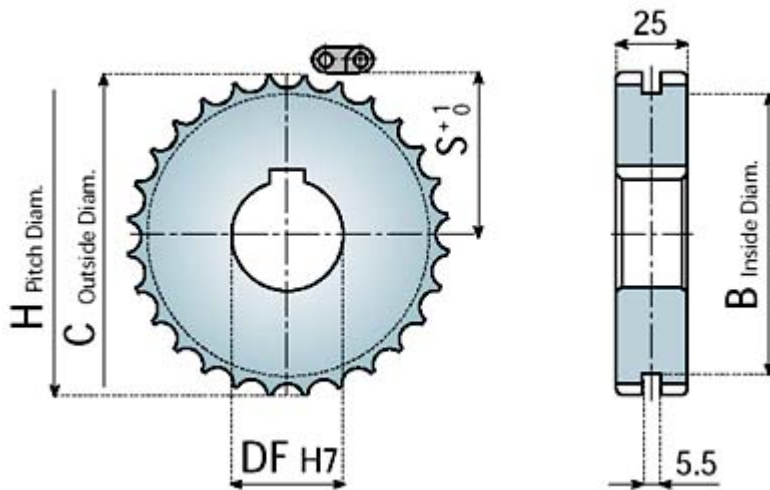

SPROCKETS for belts series

2120 H-FT / VG / LBP



STANDARD SPROCKETS SINGLE KEYWAY

Material: polyamide, DIN 6885 key seat.

Notes:

- Special shape of teeth compensates natural belt lengthening after prolonged use.

Features:

- Excellent wear and chemical resistance.
- Reduced noise level and quiet operation.
- Reinforced design.
- Completely closed structure, easier to clean and to disinfect
- The design of the sprocket ensures smooth running and long service life.
- Increased keyway strenght.

CODE	Z	C mm	H mm	B mm	S mm	DF mm
125500GF	16	65.2	65.10	55	28.2	18*
125500F						25
125501F						30
125502GF	20	81.2	81.19	71	36.3	18*
125502F						25
125503F						30
125504F						35
125505F						40
125506GF	24	97.4	97.30	87	44.3	18*
125506F						25
125507F						30
125508F						35
125509F						40
125510GF	28	113.4	113.43	103	52.4	18*
125510F						25
125511F						30
125512F						35
125513F						40

*Plain Bore

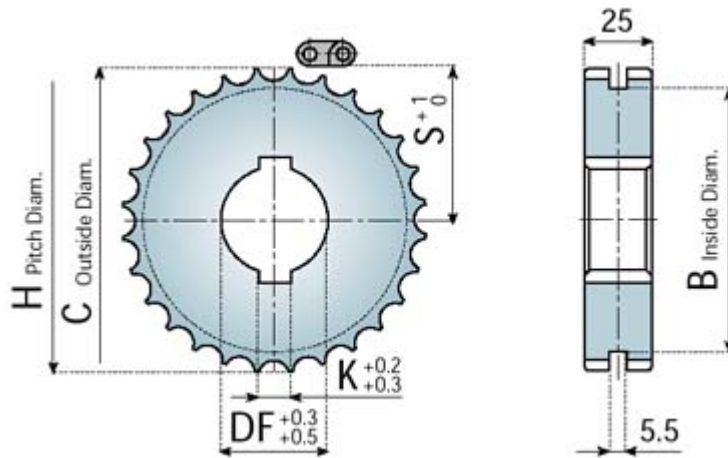
SPROCKETS for belts series**2120 H-FT / VG / LBP****STANDARD SPROCKETS DOUBLE KEYWAY**

Material: polyamide, DIN 6885 key seat.

Notes:

- These sprockets can be used on the drive on the idler shaft. They float freely on the shaft.
- Special shape of teeth compensates natural belt lengthening after prolonged use.

Features:

- Excellent wear and chemical resistance.
- Reduced noise level and quiet operation.
- Reinforced design.
- Completely closed structure, easier to clean and to disinfect
- The design of the sprocket ensures smooth running and long service life.
- Increased keyway strenght.

CODE	Z	C mm	H mm	B mm	S mm	DF mm
125551F	16	65.2	65.10	55	28.2	25
125552F						30
125553F	20	81.2	81.19	71	36.3	30
125554F						40
125555F	24	97.4	97.30	87	44.3	30
125556F						40
125557F	28	113.4	113.43	103	52.4	30
125558F						40

SPROCKETS for belts series**2120 H-FT / VG / LBP**

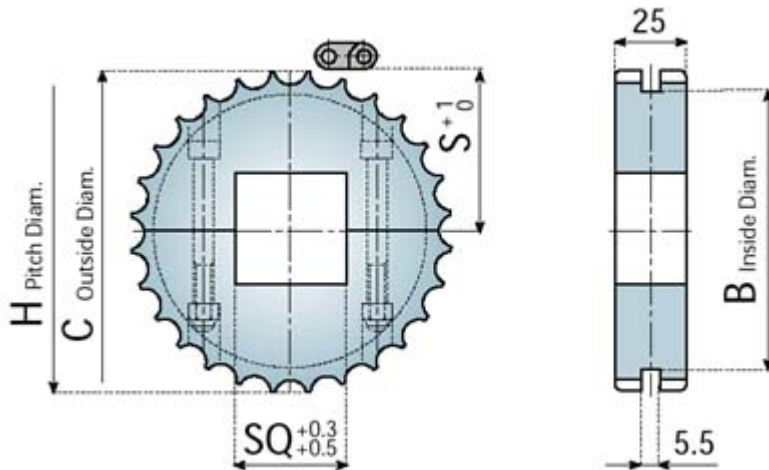

SPLIT SPROCKETS SQUARE BORE

Material: polyamide.

Notes:

- These sprockets can be used on the drive on the idler shaft. They float freely on the shaft.
- Special shape of teeth compensates natural belt lengthening after prolonged use.

Features:

- Excellent wear and chemical resistance.
- Reduced noise level and quiet operation.
- Reinforced design.
- Completely closed structure, easier to clean and to disinfect
- The design of the sprocket ensures smooth running and long service life.

CODE	Z	C mm	H mm	B mm	S mm	SQ mm
125650F	28	113.4	113.43	103	52.4	30x30
125651F						40x40

SPROCKETS for belts series

2120 H-FT / VG / LBP

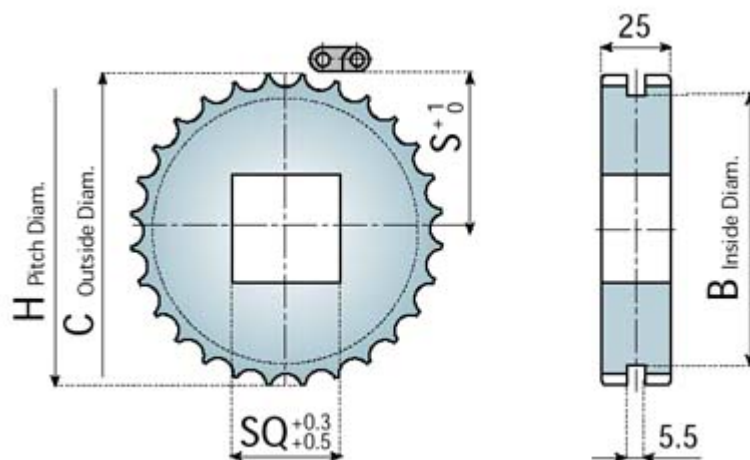

STANDARD SPROCKETS SQUARE BORE

Material: polyamide.

Notes:

- These sprockets can be used on the drive on the idler shaft. They float freely on the shaft.
- Special shape of teeth compensates natural belt lengthening after prolonged use.

Features:

- Excellent wear and chemical resistance.
- Reduced noise level and quiet operation.
- Reinforced design.
- Completely closed structure, easier to clean and to disinfect
- The design of the sprocket ensures smooth running and long service life.

CODE	Z	C mm	H mm	B mm	S mm	SQ mm
125700F	16	65.2	65.10	55	28.2	25x25
125701F						30x30
125702F	20	81.2	81.19	71	36.3	25x25
125703F						30x30
125704F						35x35
125705F	24	97.4	97.30	87	44.3	25x25
125706F						30x30
125707F						40x40
125708F						25x25
125709F	28	113.4	113.43	103	52.4	30x30
125710F						40x40

SPROCKETS for belts series

2120 H-FT / VG / LBP

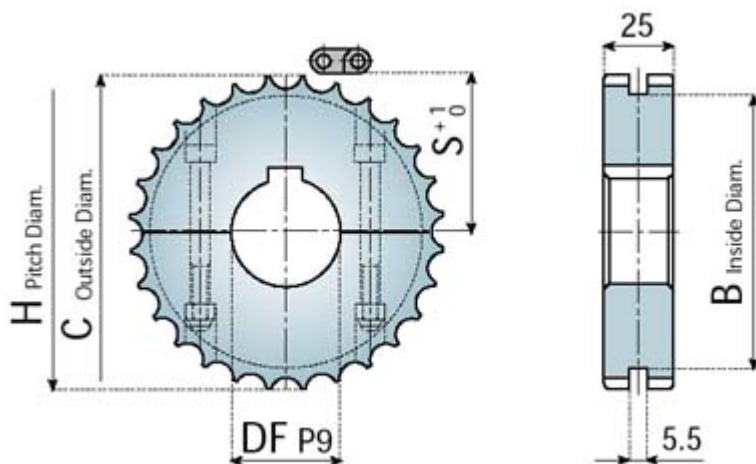

SPLIT SPROCKETS SINGLE KEYWAY

Material: polyamide screws in stainless steel, DIN 6885 key seat.

Notes:

- These sprockets can be used for belt widths up to 680 mm and temperature differences of maximum 30°C.
- For wider belts or bigger temperature differences, sprockets with square bores or round bore
- with two keyway have to be used.

Features:

- Excellent wear and chemical resistance.
- Reduced noise level and quiet operation.
- Reinforced design.

- Completely closed structure, easier to clean and to disinfect
- The design of the sprocket ensures smooth running and long service life.

CODE	Z	C mm	H mm	B mm	S mm	DF mm
125600GF	28	113.4	113.43	103	52.4	18*
125600F						25
125601F						30
125602F						35
125603F						40

*Plain Bore

SPROCKETS for belts series

2120 H (version FT / VG / LBP)

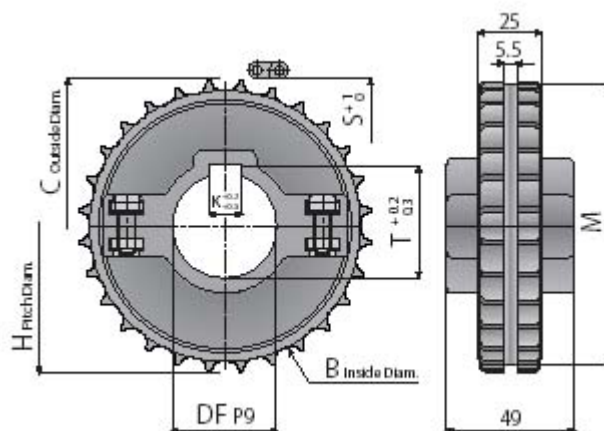

SPLIT SPROCKETS SINGLE KEYWAY

Features:

- Excellent wear and chemical resistance.
- Reduced noise level and quiet operation.
- Reinforced design.
- Completely closed structure, easier to clean and to disinfect
- The design of the sprocket ensures smooth running and long service life.
- Increased keyway strength.

Material: reinforced polyamide, screws in stainless steel, nut in nickel plated brass.

To order single keyway sprockets capable of floating freely on the shaft (i.e. bore tolerance DF +0.3 /+0.5), just add the letter "P" (=plus) to the existing part number.
For example, code 123000P.

CODE	Z	B mm	C mm	H mm	M mm	S mm	DF mm
123000	28	104.7	113.4	113.4	103	52.4	30
123001							35
123002							40
123003							45

SPROCKETS for belts series

2120 H (version FT / VG / LBP)



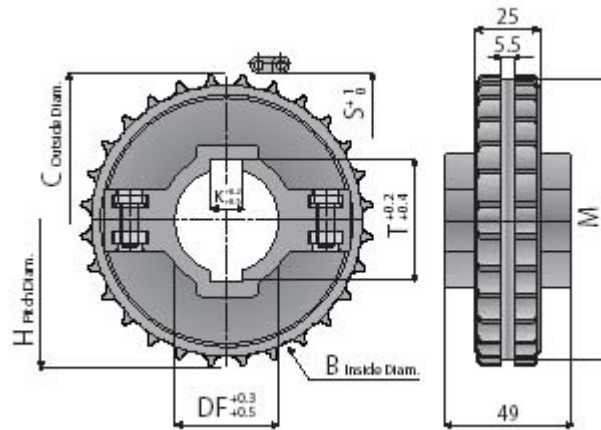

SPLIT SPROCKETS DOUBLE KEYWAY

Material: reinforced polyamide, screws in stainless steel, nut in nickel plated brass.

Notes:

- These sprockets can be used on the drive and on the idler shaft. They float freely on the shaft.

Features:

- Excellent wear and chemical resistance.
- Reduced noise level and quiet operation.
- Reinforced design.
- Completely closed structure, easier to clean and to disinfect
- The design of the sprocket ensures smooth running and long service life.
- Increased keyway strength.

CODE	Z	B mm	C mm	H mm	M mm	S mm	DF mm
123004	28	104.7	113.4	113.4	103	52.4	30
123005							35
123006							40
123007							45

SPROCKETS for belts series

2120 H (version FT / VG / LBP)

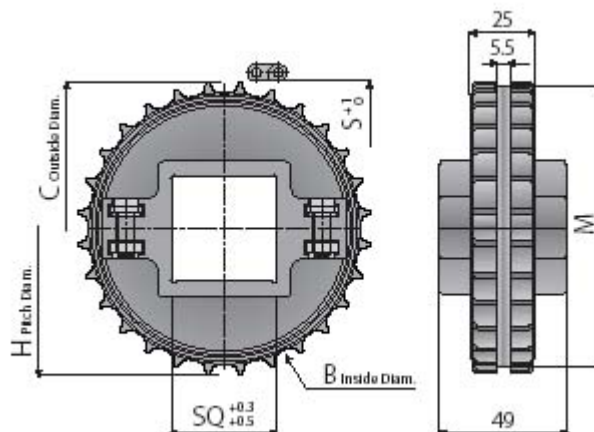

SPLIT SPROCKETS SQUARE BORE

Notes:

- ### Features:

- Excellent wear and chemical resistance.
- Reduced noise level and quiet operation.
- Reinforced design.
- Completely closed structure, easier to clean and to disinfect
- The design of the sprocket ensures smooth running and long service life.

CODE	Z	B mm	C mm	H mm	M mm	S mm	DF mm
123008	28	104.7	113.4	113.4	103	52.4	30x30
123009							40x40