

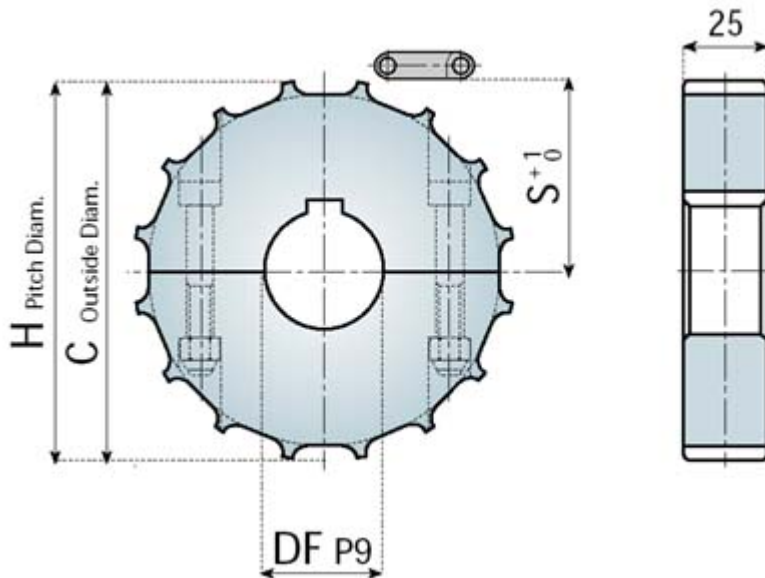

SPROCKETS for belts series

2250 FT - 2250 J-FG



SPLIT SPROCKETS SINGLE KEYWAY

Material: polyamide, screws in stainless steel.
DIN 6885 key seat.

Features:

- Excellent wear and chemical resistance.
- Reduced noise level and quiet operation
- Reinforced design.
- Completely closed structure, easier to clean and to disinfect
- The design of the sprocket ensures smooth running and long service life.
- Increased keyway strength.

Notes:

- These sprockets can be used for belt widths up to 680 mm and temperature differences of maximum 30°C.
- For wider belts or bigger temperature differences, sprockets with square bores or round bore
- with two keyway have to be used.
- Special shape of teeth compensates natural belt lengthening after prolonged use.

CODE	Z	C mm	H mm	S mm	DF mm
125000GF	12	98.0	98.14	44.7	18*
125000F					25
125001F					30
125002F					35
125003F					40
125004GF	16	130.0	130.20	60.7	18*
125004F					25
125005F					30
125006F					35
125007F					40
125008GF	18	146.0	146.27	68.8	18*
125008F					25
125009F					30

125010F					35
125011F					40
125012GF					18*
125012F					25
125013F	20	162.0	162.37	76.8	30
125014F					35
125015F					40

*Plain Bore

SPROCKETS for belts series

2250 FT - 2250 J-FG

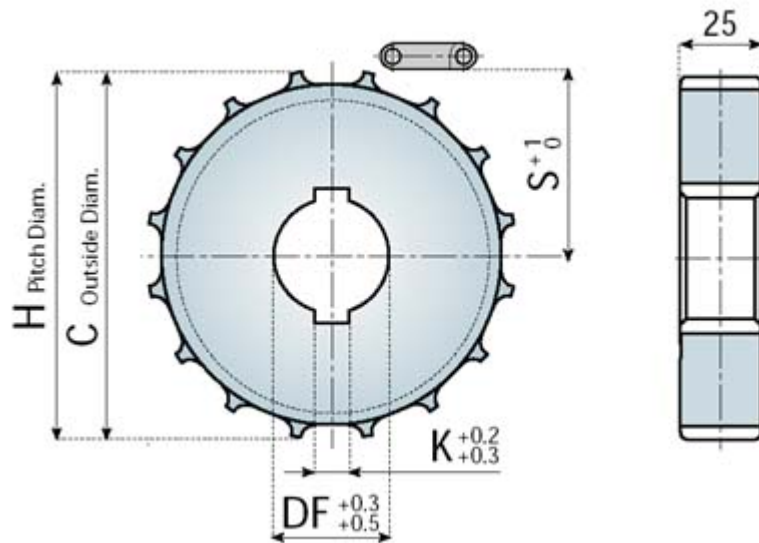

STANDARD SPROCKETS DOUBLE KEYWAY

Material: polyamide, DIN 6885 key seat.

Notes:

- These sprockets can be used on the drive and on the idler shaft. They float freely on the shaft.
- Special shape of teeth compensates natural belt lengthening after prolonged use.

Features:

- Excellent wear and chemical resistance.
- Reduced noise level and quiet operation
- Reinforced design.
- Completely closed structure, easier to clean and to disinfect
- The design of the sprocket ensures smooth running and long service life.
- Increased keyway strength.

CODE	Z	C mm	H mm	S mm	DF mm
125100GF					18*
125100F	12	98.0	98.14	44.7	30
125101F					40
125102GF					18*
125102F	16	130.0	130.20	60.7	30
125103F					40
125104GF					18*
125104F	18	146.0	146.27	68.8	30
125105F					40

125106GF	20	162.0	162.37	76.8	18*
125106F					30
125107F					40

SPROCKETS for belts series

2250 FT - 2250 J-FG

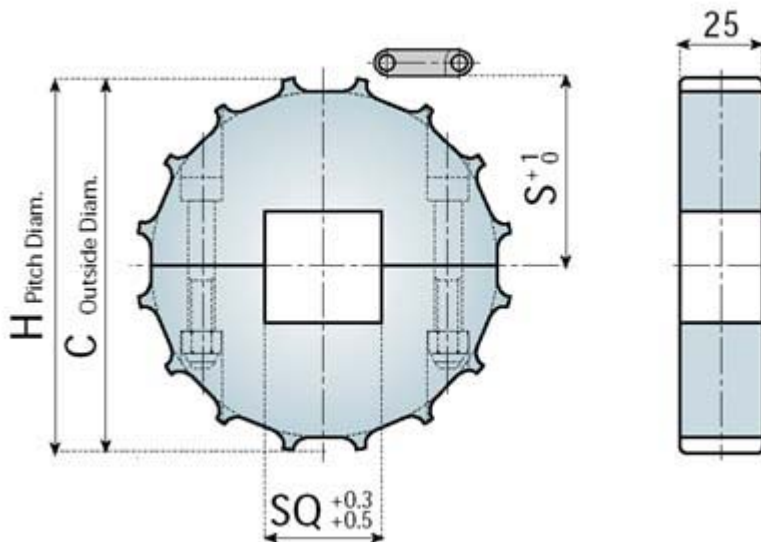

SPLIT SPROCKETS SQUARE BORE

Material: polyamide, screws in stainless steel.

Notes:

- These sprockets can be used on the drive and on the idler shaft. They float freely on the shaft.
- Special shape of teeth compensates natural belt lengthening after prolonged use.

Features:

- Excellent wear and chemical resistance.
- Reduced noise level and quiet operation.
- Reinforced design.
- Completely closed structure, easier to clean and to disinfect.
- The design of the sprocket ensures smooth running and long service life.

CODE	Z	C mm	H mm	S mm	SQ mm
125150F	12	98.0	98.14	44.7	30x30
125151F					40x40
125152F	16	130.0	130.20	60.7	30x30
125153F					40x40
125154F					60x60
125155F	18	146.0	146.27	68.8	30x30
125156F					40x40
125157F					60x60
125158F	20	162.0	162.37	76.8	30x30
125159F					40x40
125160F					60x60

SPROCKETS for belts series

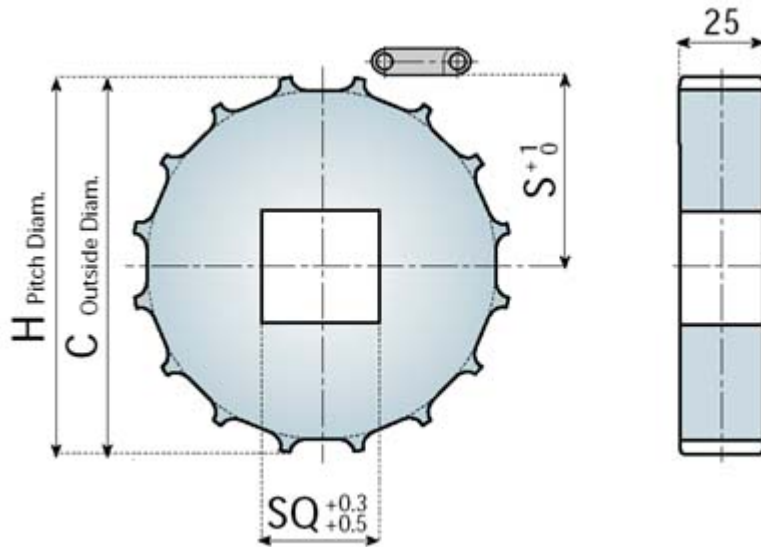
2250 FT - 2250 J-FG**STANDARD SPROCKETS SQUARE BORE**

Material: polyamide.

Notes:

- These sprockets can be used on the drive and on the idler shaft. They float freely on the shaft.
- Special shape of teeth compensates natural belt lengthening after prolonged use.

Features:

- Excellent wear and chemical resistance.
- Reduced noise level and quiet operation.
- Reinforced design.
- Completely closed structure, easier to clean and to disinfect.
- The design of the sprocket ensures smooth running and long service life.

CODE	Z	C mm	H mm	S mm	SQ mm
125200F	12	98.0	98.14	44.7	30x30
125201F					40x40
125202F	16	130.0	130.20	60.7	30x30
125203F					40x40
125204F					60x60
125205F	18	146.0	146.27	68.8	30x30
125206F					40x40
125207F					60x60
125208F	20	162.0	162.37	76.8	30x30
125209F					40x40
125210F					60x60

SPROCKETS for belts series**2250 FT - 2250 J-FG**

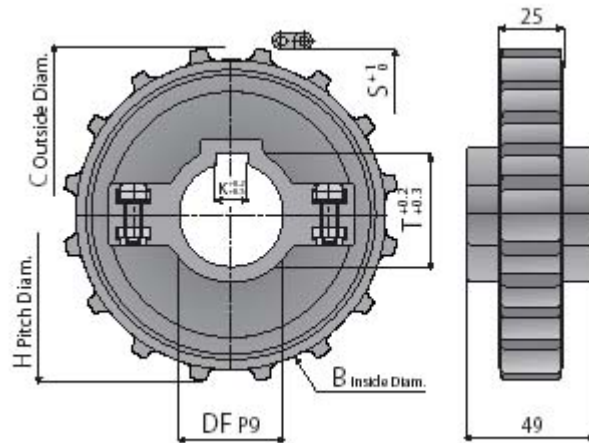

SPLIT SPROCKETS SINGLE KEYWAY

Material: reinforced polyamide, screws in stainless steel, nut in nickel plated brass.

Features:

- Excellent wear and chemical resistance.
- Reduced noise level and quiet operation.
- Reinforced design.
- Completely closed structure, easier to clean and to disinfect
- The design of the sprocket ensures smooth running and long service life.
- Increased keyway strength.

To order single keyway sprockets capable of floating freely on the shaft (i.e. bore tolerance $DF +0.3 / +0.5$), just add the letter "P" (=plus) to the existing part number.

For example, code **123015P**.

CODE	Z	B mm	C mm	H mm	S mm	DF mm
123015	16	120.0	130.0	130.2	60.7	30
123016						35
123017						40
123018						45
123029	18	136.2	146.0	146.3	68.8	30
123030						35
123031						40
123032						45
123043	20	152.2	162.0	162.4	76.8	30
123044						35
123045						40
123046						45

SPROCKETS for belts series

2250 FT - 2250 J-FG



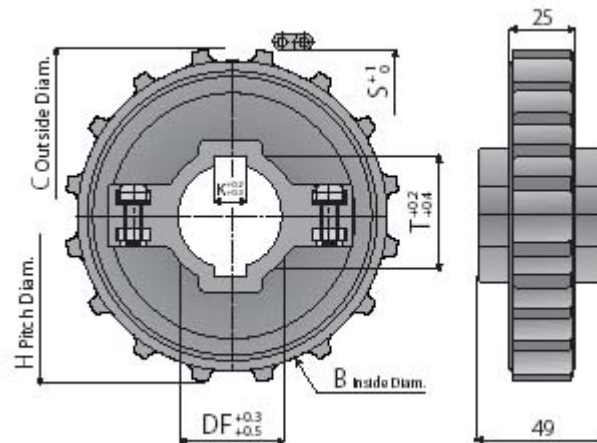

SPLIT SPROCKETS DOUBLE KEYWAY

Material: reinforced polyamide, screws in stainless steel, nut in nickel plated brass.

Notes:

- These sprockets can be used on the drive and on the idler shaft. They float freely on the shaft.

Features:

- Excellent wear and chemical resistance.
- Reduced noise level and quiet operation.
- Reinforced design.
- Completely closed structure, easier to clean and to disinfect
- The design of the sprocket ensures smooth running and long service life.
- Increased keyway strength.

CODE	Z	B mm	C mm	H mm	S mm	DF mm
123019	16	120.0	130.0	130.2	60.7	30
123020						35
123021						40
123022						45
123033	18	136.2	146.0	146.3	68.8	30
123034						35
123035						40
123036						45
123047	20	152.2	162.0	162.4	76.8	30
123048						35
123049						40
123050						45

SPROCKETS for belts series

2250 FT - 2250 J-FG



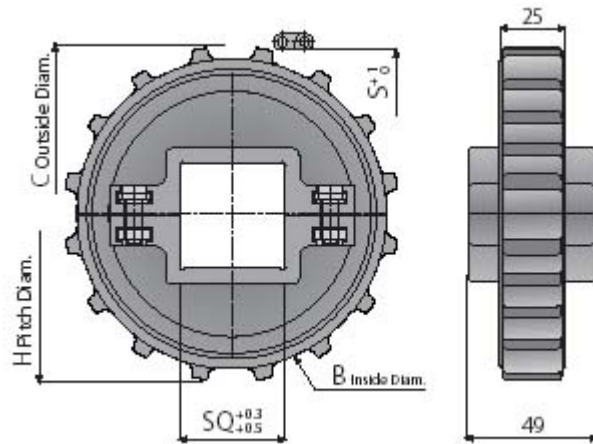

SPLIT SPROCKETS SQUARE BORE

Material: reinforced polyamide, screws in stainless steel, nut in nickel plated brass.

Notes:

- These sprockets can be used on the drive and on the idler shaft. They float freely on the shaft.

Features:

- Excellent wear and chemical resistance.
- Reduced noise level and quiet operation.
- Reinforced design.
- Completely closed structure, easier to clean and to disinfect
- The design of the sprocket ensures smooth running and long service life.

CODE	Z	B mm	C mm	H mm	S mm	DF mm
123023	16	120.0	130.0	130.2	60.7	30x30
123024						40x40
123037	18	136.2	146.0	146.3	68.8	30x30
123038						40x40
123051	20	152.2	162.0	162.4	76.8	30x30
123052						40x40