

# Clamps for conical side guides



New design

## SINGLE RAIL CLAMP

**Material:** stainless steel AISI 304, thickness  $S = 2$  mm.

**Packaging:** 50 pieces.

**Use:** to support conical guide.

**Note:** round hole version accepts a M8 bolt and square hole version accepts a M8 carriage bolt.

Available in two lengths 38.1 mm wide and 76.2 mm wide for splicing. Tightening bolt not included.

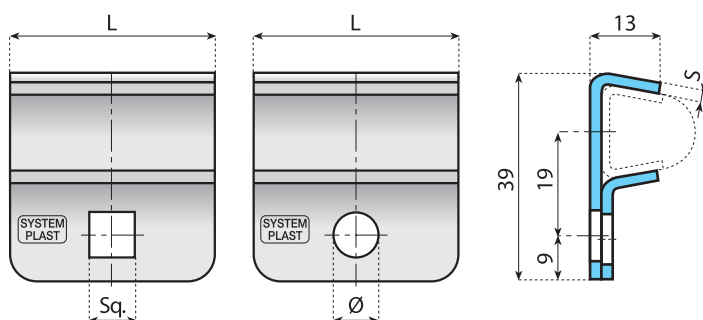

Code	L mm	Ø ●	Sq. ■
13014	38.1	8.1	—
13014S	38.1	—	9
13014L	76.2	8.1	—
13014SL	76.2	—	9

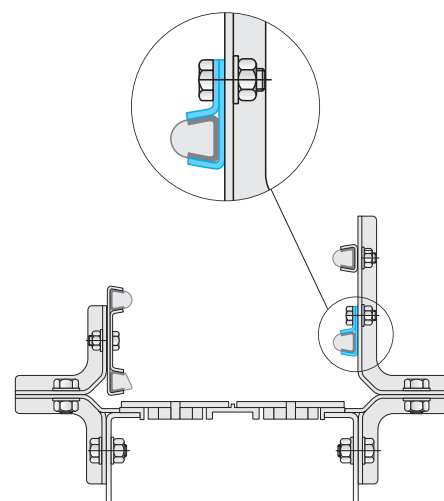

304 Stainless steel

For sufficient quantities parts can be produced in



Zinc plated steel

New range and design

## SINGLE RAIL CLAMP WITH THREADED INSERT

**Material:** stainless steel AISI 304, thickness  $S = 2$  mm.

**Packaging:** 50 pieces.

**Use:** two piece compression style for easy assembly and adjustment. Nut and washer not included.

**Note:** max recommended tightening torque 2.0 Kgm.

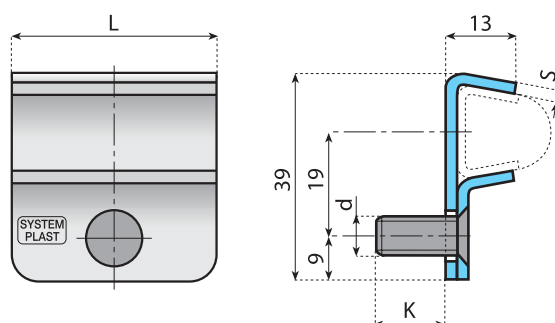

Code	L mm	K mm	d thread size
131016	38.1	16	M8
131017	38.1	21	M8
131018	38.1	26	M8
131019	38.1	31	M8

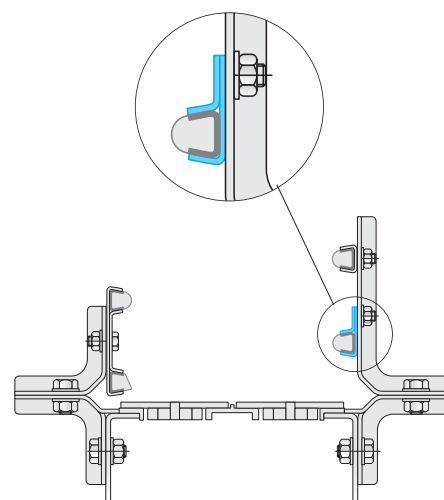

304 Stainless steel

For sufficient quantities parts can be produced in



Zinc plated steel

# Clamps for conical side guides



*New design*

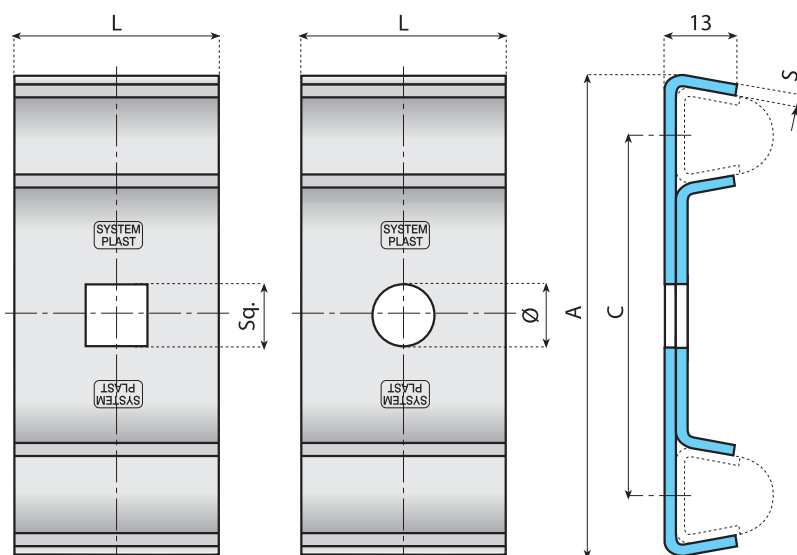

**SS 304**

304 Stainless steel

For sufficient quantities parts can be produced in

**Zn**

Zinc plated steel

## DOUBLE RAIL CLAMP

**Material:** stainless steel AISI 304, thickness  $S = 2.5$  mm.

**Packaging:** 50 pieces.

**Use:** to support conical guide.

**Note:** round hole version accepts a M8 bolt and square hole version accepts a M8 carriage bolt.

Available in two lengths 38.1 mm wide and 76.2 mm wide for splicing. Tightening bolt not included.

Code	L mm	A mm	C mm	Ø ● mm	Sq. ■ mm
13013	38.1	86	63.5	10.5	—
13013S	38.1	86	63.5	—	9
13013L	76.2	86	63.5	10.5	—
13013SL	76.2	86	63.5	—	9
131001	38.1	106.5	84	10.5	—
131001S	38.1	106.5	84	—	9
131001L	76.2	106.5	84	10.5	—
131001SL	76.2	106.5	84	—	9
131002	38.1	117.7	95.2	10.5	—
131002S	38.1	117.7	95.2	—	9
131002L	76.2	117.7	95.2	10.5	—
131002SL	76.2	117.7	95.2	—	9

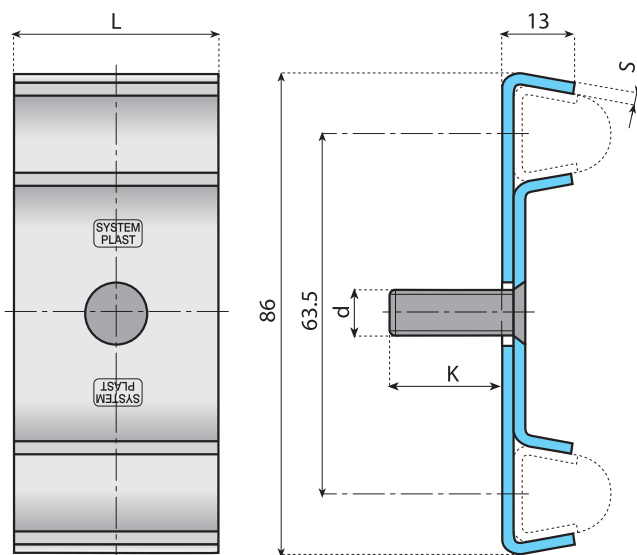
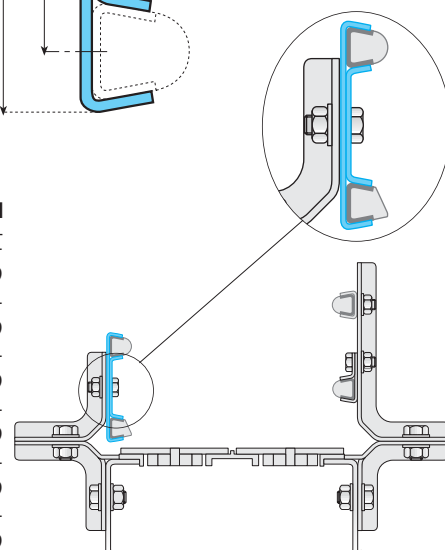

For sufficient quantities parts can be produced in

**Zn**

Zinc plated steel

**SS 304**

304 Stainless steel

## DOUBLE RAIL CLAMP WITH THREADED INSERT

**Material:** stainless steel AISI 304, thickness  $S = 2.5$  mm.

**Packaging:** 50 pieces.

**Use:** two piece compression style for easy assembly and adjustment. Nut and washer not included.

**Note:** max recommended tightening torque 3.0 Kgm.

Code	L mm	K mm	d thread size
131020	38.1	16	M8
131021	38.1	21	M8
131022	38.1	26	M8
131023	38.1	31	M8

*New range and design*

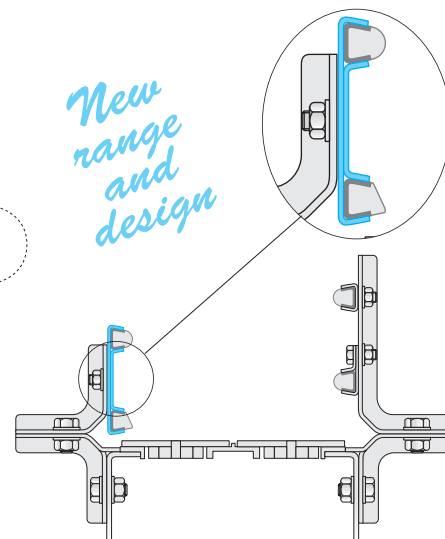

# Clamps for conical side guides



*New*

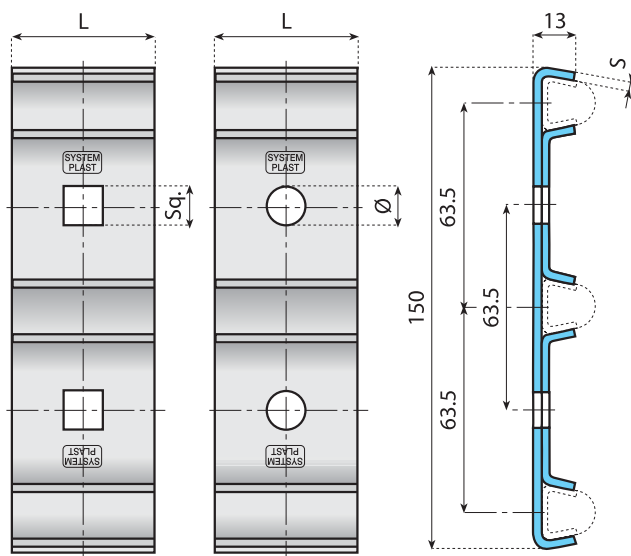

For sufficient quantities parts can be produced in



Zinc plated steel



304 Stainless steel

## TRIPLE RAIL CLAMP

**Material:** stainless steel AISI 304, thickness  $S = 2.5$  mm.

**Packaging:** 50 pieces.

**Note:** used with toll containers or when large and small containers run on the same production line. Tightening bolt not included.

Code	L mm	Ø ●	Sq. ■
131003	38.1	10.5	-
131003S	38.1	-	9

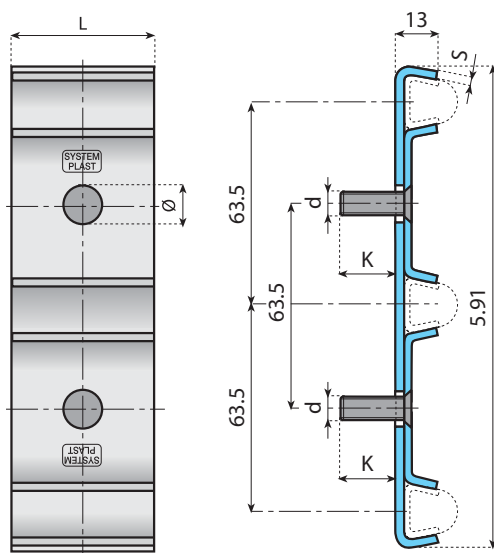
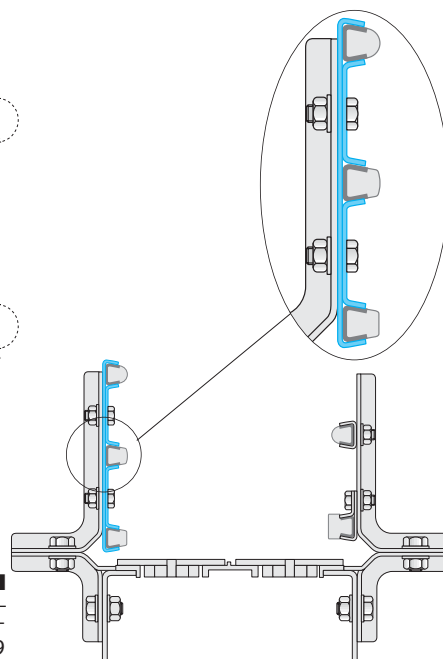

For sufficient quantities parts can be produced in



Zinc plated steel



304 Stainless steel

## TRIPLE RAIL CLAMP WITH THREADED INSERT

**Material:** stainless steel AISI 304, thickness  $S = 2.5$  mm.

**Packaging:** 50 pieces.

**Use:** two piece compression style for easy assembly and adjustment. Nut and washer not included.

**Note:** max recommended tightening torque 3.0 Kgm.

Code	L mm	K mm	d thread size
131024	38.1	16	M8
131025	38.1	21	M8
131026	38.1	26	M8
131027	38.1	31	M8

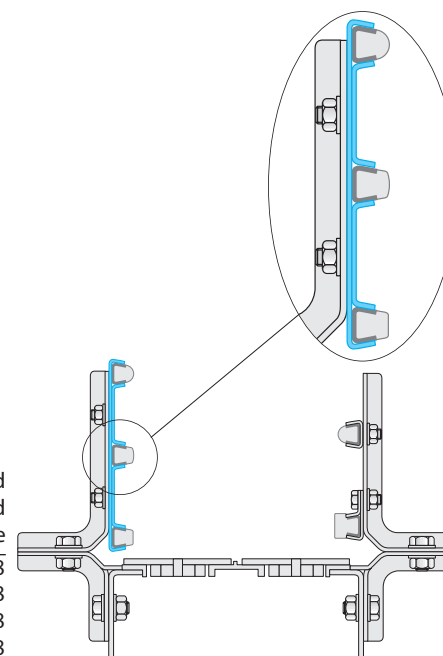

## Clamp for conical side guides

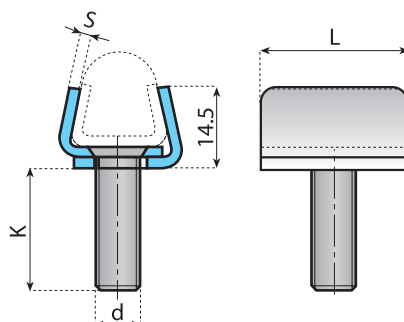

### HEAVY DUTY CLIP

**Material:** stainless steel AISI 304, thickness  $S = 2.5$  mm.

**Packaging:** 100 pieces.

**Use:** two piece compression style for easy assembly and adjustment. Nut and washer not included.

**Note:** max recommended tightening torque 2.0 Kgm.

Code	L mm	K mm	d thread size
131004	26	16	M8
131005	26	21	M8
131006	26	26	M8
131007	26	31	M8

For sufficient quantities parts can be produced in



Zinc plated steel



304 Stainless steel

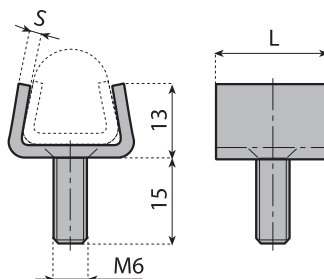

### SINGLE CLAMP

**Material:** stainless steel AISI 304, thickness  $S = 2.5$  mm.

**Packaging:** 100 pieces.

**Use:** easy assembly of guide profiles.

**Note:** max recommended tightening torque 1.8 Kgm.

Code	L mm
13796	20

Light duty

For sufficient quantities parts can be produced in



Zinc plated steel



304 Stainless steel

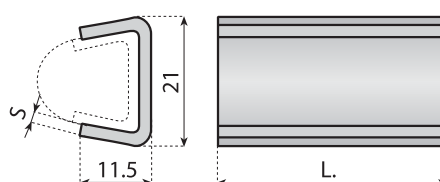

### CONNECTING ELEMENT

**Material:** stainless steel AISI 304, thickness  $S = 2.5$  mm.

**Packaging:** 50 pieces.

**Use:** to connect two guide rails.

The part can be tapped on with a hammer.

Code	L mm
13015	38
13120	50

For sufficient quantities parts can be produced in



Zinc plated steel



304 Stainless steel