

# Quick positioning cross block

 Preferred type, readily available (codes marked in red)

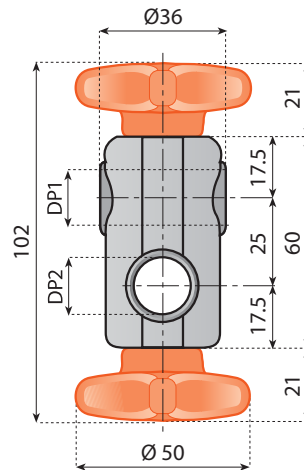

AISI 304  
Stainless steel



Nickel plated brass



Reinforced  
polyamide



Accessories

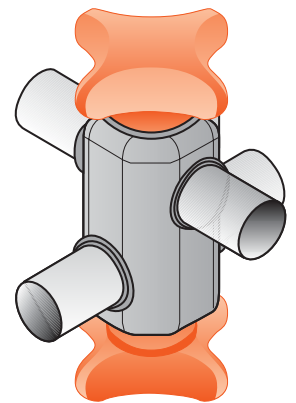

## QUICK RELEASE CROSS BLOCK

**Material:** housing in reinforced polyamide, hardware in stainless steel, knobs in polyamide with bushings in nickel plated brass.

**Features:** it connects two round rods at 90°. Each side of the cross block can be quickly adjusted by loosening the hand knob.

**Supply:** assembled.

Code	DP1	DP2	
<b>13316</b>	12	12	n°50
<b>13317</b>	12	14	
<b>13318</b>	12	16	
<b>13319</b>	14	14	
<b>13320</b>	14	16	
<b>13321</b>	16	16	

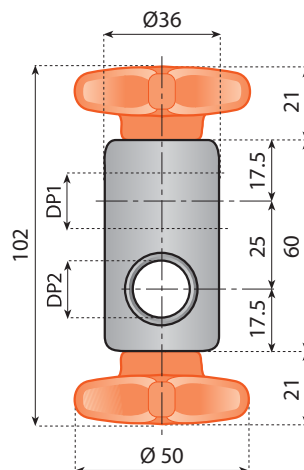

## QUICK RELEASE CROSS BLOCK

**Material:** body in stainless steel, hardware in stainless steel, knobs in polyamide with bushings in nickel plated brass.

**Features:** it connects two round rods at 90°. Each side of the cross block can be quickly adjusted by loosening the hand knob.

**Supply:** assembled.

Code		DP1	DP2	
with knobs colour				
Orange	Black			
<b>13360V</b>	<b>13360VN</b>	12	12	n°50
<b>13361V</b>	<b>13361VN</b>	12	14	
<b>13362V</b>	<b>13362VN</b>	12	16	
<b>13363V</b>	<b>13363VN</b>	14	14	
<b>13364V</b>	<b>13364VN</b>	14	16	
<b>13365V</b>	<b>13365VN</b>	16	16	

# Quick positioning cross block

Preferred type, readily available (codes marked in red)

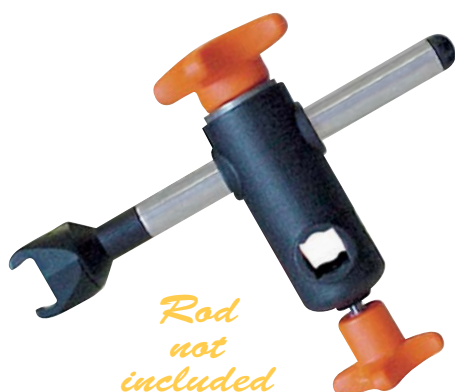

*Rod  
not  
included*

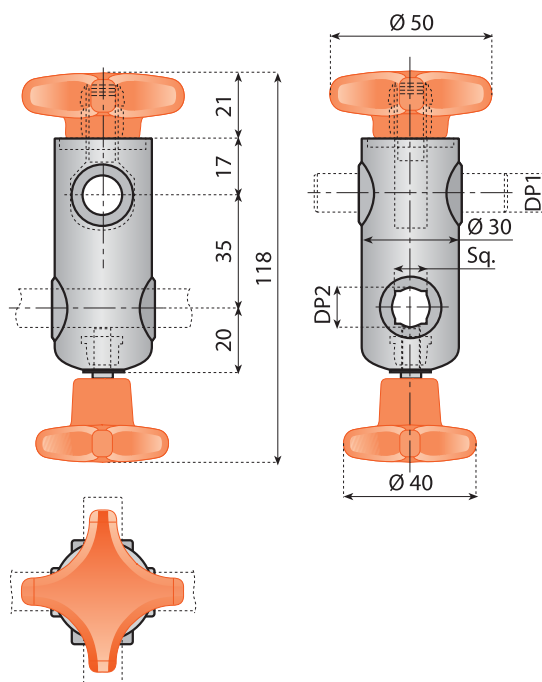

## CROSS BLOCK WITH KNOBS

### Components:

- Housing in reinforced polyamide.
- Washer and hardware in stainless steel.
- Knobs in reinforced polyamide with one threaded insert in stainless steel and one brass bushing.

### Features:

- Connects two round rods or one round rod with square bar at 90°.
- Each side of the cross block can be quickly adjusted by loosening the hand knob.

**Supply:** assembled.

Code	DP1	DP2		
		●	■	
<b>13310V</b>	12	12	10	n°50
<b>13311V</b>	12	14	12	
<b>13322V</b>	14	12	10	
<b>13312V</b>	14	14	12	



*Rod  
not  
included*

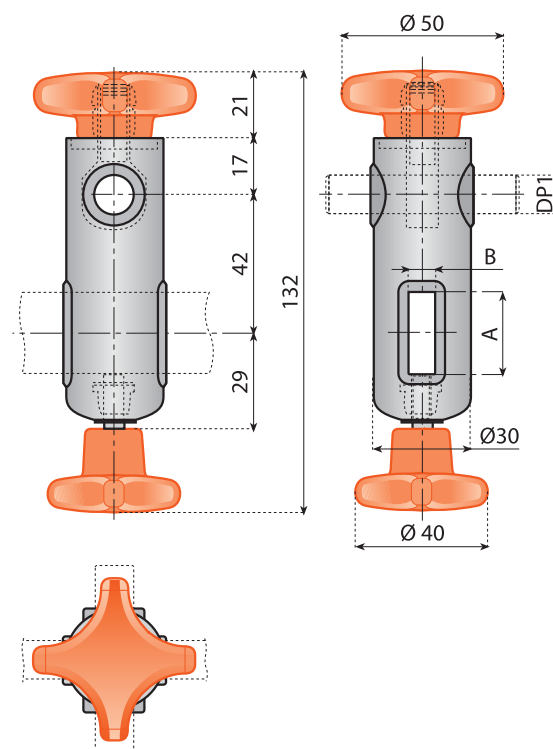

## CROSS BLOCK WITH KNOBS

### Components:

- Housing in reinforced polyamide.
- Washer and hardware in stainless steel.
- Knobs in reinforced polyamide with one threaded insert in stainless steel and one brass bushing.

### Features:

- Connects one round rod with flat bar at 90°.
- Each side of the cross block can be quickly adjusted by loosening the hand knob.

**Supply:** assembled.

Code	DP1	FLAT BAR A x B	
<b>13260V</b>	12	25 x 8	n°50
<b>13261V</b>	14	25 x 8	
<b>13262V</b>	12	25 x 6	
<b>13263V</b>	14	25 x 6	